

Models: DT810 / DT820

Pre-assembled and ready to operate. Just make an electrical connection.

Seamless Fiberglass Construction is immune to heat, cold, and bad weather.



Electric-powered – No fumes, fuel or diesel engine noise.

Can be placed anywhere – grass, gravel, or relatively uneven surfaces.

Approvals:

- NSF listed
- UL Class I foam

Insulation:

- Polyisocyanurate foam: 4" thick X 2.0 PCF nominal density

Fiberglass:

- 100 mil thick FRP composite – exterior
- 80 mil thick FRP composite – interior

Exterior Finish:

- Seamless fiberglass
- 2 part epoxy paint

Interior Finish:

- NSF approved flooring – non-skid floor finish – 29 grade sand aggregate
- Rounded corners, sanitary

- | | |
|--|---|
| <ul style="list-style-type: none"> ▪ Heavy Duty non-skid floor ▪ Lockable Door latch ▪ Self-Closing Hinges ▪ Hasp lock (ext. door) ▪ Safety Release Handle ▪ Heated Door Jamb ▪ Magnetic gasket ▪ Door Closer ▪ Sweep Seal ▪ Vinyl Strip Curtain ▪ Galvanized Frame | <ul style="list-style-type: none"> ▪ Low ambient controls ▪ Defrost timer ▪ Heated relief port ▪ Light switch/pilot light ▪ Rain cap exterior doors ▪ Remote dial thermometer ▪ Interior lighting ▪ Crowned roof ▪ Heated freezer door ▪ Stainless Steel Kick Plate ▪ Forklift Capable frame |
|--|---|

Specs:

- Flame spread index < 25
- Smoke developed index < 185
- Floor Strength: 900 lb/ft²
- Forklift Slots: 3" x 8" SQ TU, 37" apart on center

Box Layout

DT810 Plan View

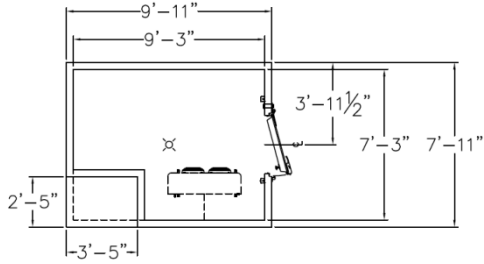

DT820 Plan View

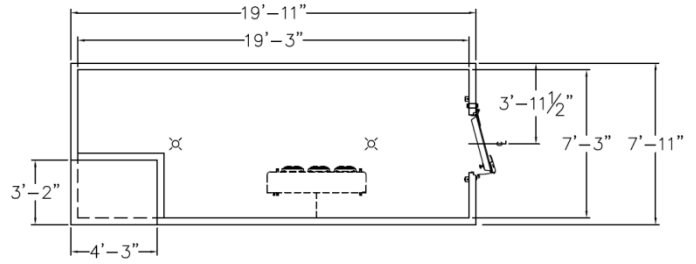

DT810 Elevation View

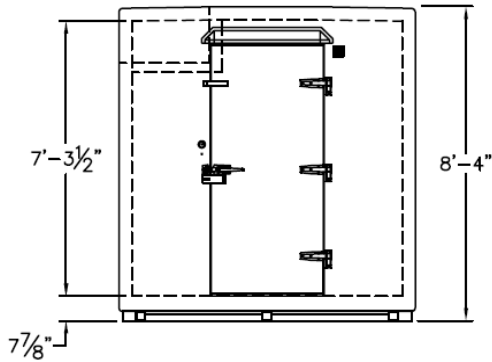

DT820 Elevation View

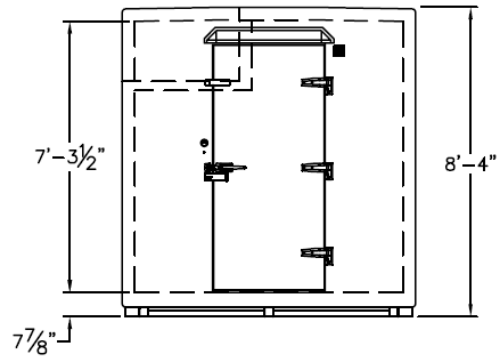

Specifications

Model	DT810	DT820
Exterior Width	7'-11"	7'-11"
Exterior Length	9'-11"	19'-11"
Exterior Height	8'-4"	8'-4"
Interior Width	7'-3"	7'-3"
Interior Length	9'-3"	19'-3"
Interior Height	7'-3 1/2"	7'-3 1/2"
Interior Area	67 ft ²	140 ft ²
Interior Volume	489 ft ³	1018 ft ³
Incandescent Lights	1	2
Condensing Unit	FFAP-020Z-CFV	DJAF-024Z-CFV
Horsepower	2	2 1/4
Coil	AE26-92B	AE36-140B
Temperature	-10°F to 35°F	-10°F to 35°F
Refrigerant	R-404a	R-404a
Electrical Supply	208-230/110V	208-230/110V
Phase	1	1
Cycle	60 Hz	60 Hz
MCA	19.6 A	27.4 A
35°F Capacity	15,000 BTU/Hr @ 90°F	21,900 BTU/Hr @ 90°F
-10°F Capacity	6,060 BTU/Hr @ 90°F	8,810 BTU/Hr @ 90°F
Door Opening	33 1/4" x 78 1/2"	33 1/4" x 78 1/2"
Empty Weight	2000 lb.	4000 lb.