

TYPICAL WIRE CONNECTIONS

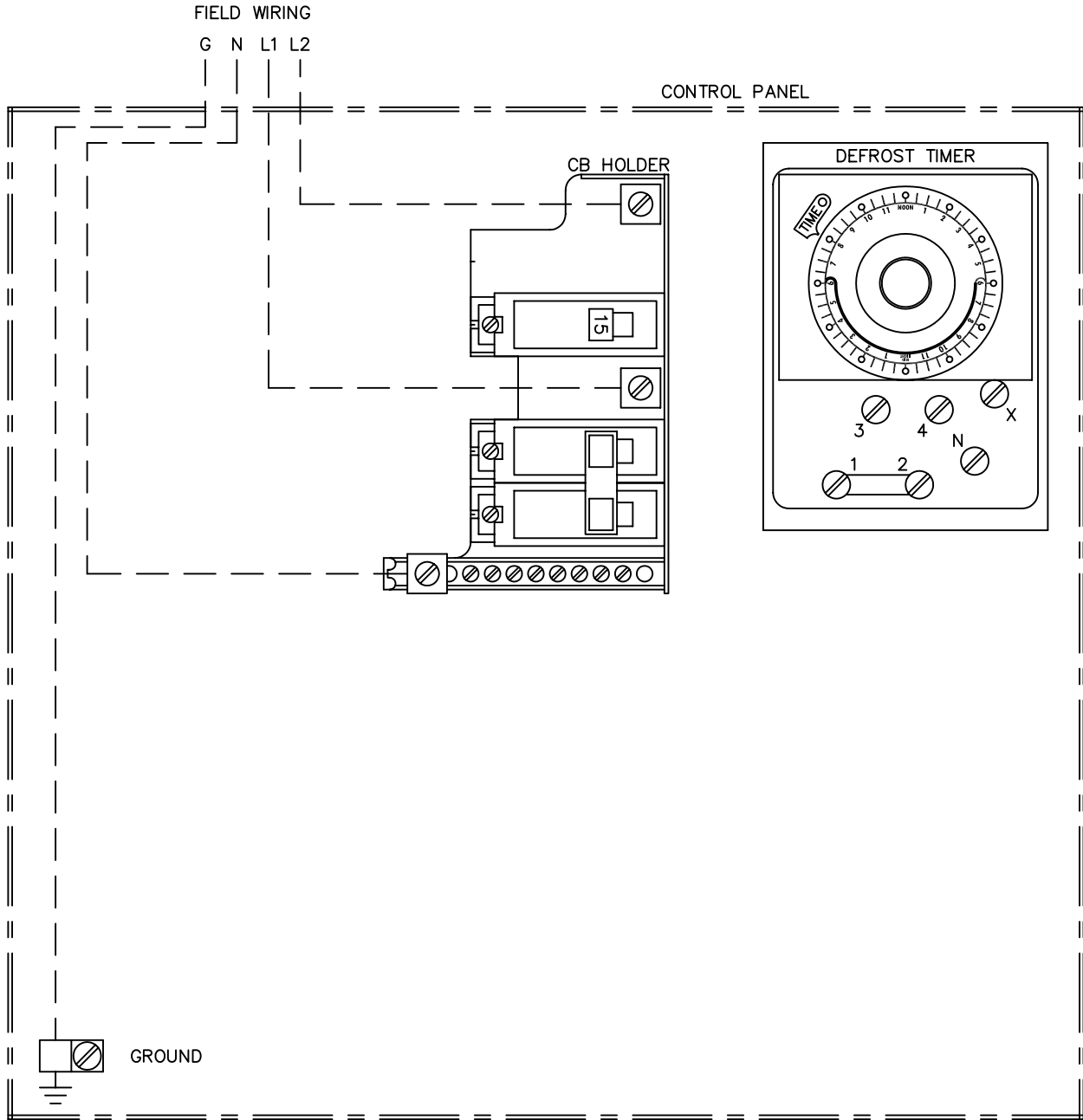

WIRING INSTRUCTIONS

CONTROL PANEL IS LOCATED AT THE CONDENSING UNIT ON TOP OF THE WALK-IN. A HOLE MAY BE DRILLED THRU THE FIBERGLASS CONDENSING UNIT COVER FOR INCOMING POWER. ELECTRICAL HOOK-UP MUST COMPLY WITH THE NATIONAL ELECTRICAL CODE

WALK-IN TYPE: Cooler or Freezer		COMPRESSOR TYPE:	
VOLTAGE: 208-230	PHASE: Single	CYCLES: 60 hz	HORSEPOWER: 1/2 to 2
DRAWN BY: MD Leppke	MODEL NO.:	SCALE: None	DATE: 3-13-03
DRAWING NAME: Single Phase Connections			